

Notes

1. Material is FlamLINE.
2. This detail illustrates a typical application.
Refer to project specific details for more information.
3. FlamLINE flange may be trimmed to a min. width of 2" when adhered into epoxy.
4. Ensure that FlamLINE is temporarily secured until epoxy cures.

PLAN / SECTION

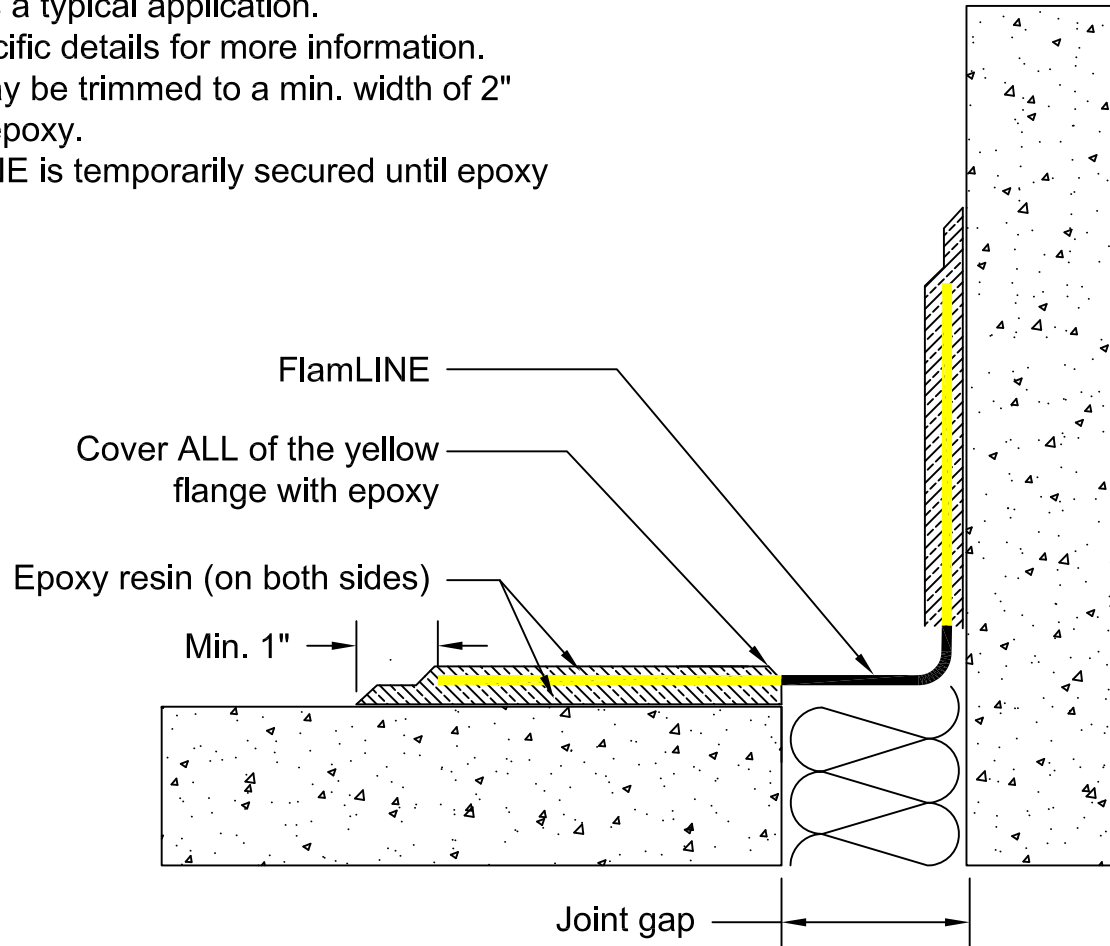

DETAIL NAME:

**FlamLINE® Waterproof Expansion Joint
installed into Epoxy Resin
(Deck-to-Wall / Wall-to-Wall)**

DETAIL NUMBER:

FL-ERA-02

SCALE:

NTS

CHECKED BY:

KMZ

DATE:

06/01/07

SHEET:

1 of 1

APPROVALS AND SIGN OFFS

DESCRIPTION	DATE	SIGNED BY:
REVISION #1	01/01/17	SL
REVISION #2		
REVISION #3		
REVISION #4		
REVISION #5		

As a supplier of finished products only, SITURA INC., does not assume responsibility for errors in design, engineering or dimensions. The architect or owner's representative must verify all dimensions and suitability of details. RedLINE®, FlamLINE®, AquaLINE® are registered trade marks of SITURA INC. © Copyright SITURA 2017.